

## METAL BACK BOXES - UL LISTED

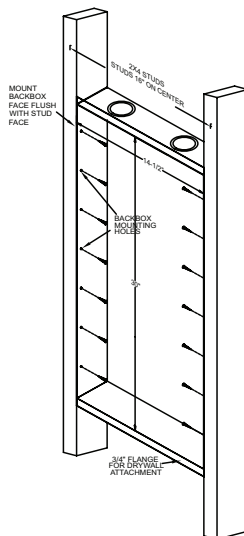

Attach back box to framing.

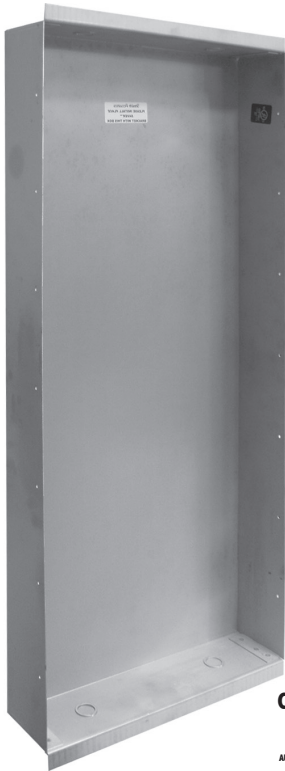
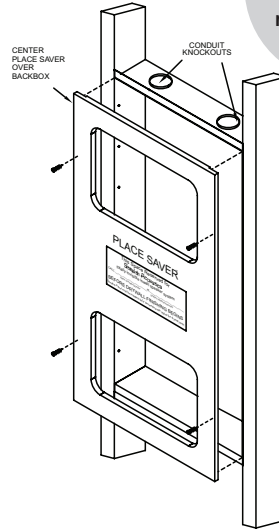

Attach Place Saver™  
(Sold separately.)

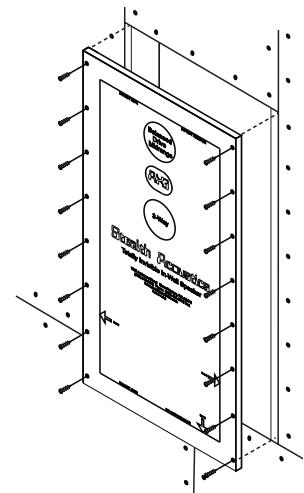

Hang speaker panel  
(Remove Place Saver™)

Must install Place Saver™ to ensure proper rough opening.

**Recommended Applications:**  
Use the MBX-30 (for LR3 and B30 panels,) the MBX-22 (for the LR8, SLR8, and B22,) or the MBX-12 (for the LR6) metal back boxes on installations where the space behind the speaker panel is open, or where a metal enclosure behind the speaker is required. Measuring 3-1/2" (89 mm) deep, the MBX series of back boxes will fit into standard 2x4 stud bays or larger apertures and are designed to fit in between 16" (406 mm) on-center studs. MBX back boxes can be used in walls or ceilings. This product is also useful to assist in installations where sound transfer from one floor or room to the next is of concern.

**Construction:**  
Constructed of 1.1 mm thick metal, MBX back boxes are shipped fully assembled and are UL listed. Convenient knockouts for conduit are provided, 2 each on the top and bottom of the box. The knockouts will accept either 1/2" (13 mm) or 3/4" (19 mm) conduits and loom clamps.

**Included Accessories:**  
Screw package and foam pads

**Optional Accessories:**  
Metal Stud C-Channel Blocking Kit (CC-Kit)

**Shipping Weight:**  
MBX-12 8 lbs. (3.6 kg) each  
MBX-22 10 lbs. (4.5 kg) each  
MBX-30 13 lbs. (5.9 kg) each

**Dimensions:**

Model:	MBX-30	MBX-22	MBX-12
Use With:	LR3, B30	LR8, SLR8, B22	LR6
Width:	14-1/2" (368 mm)	14-1/2" (368 mm)	14-1/2" (368 mm)
Height:	30" (762 mm)	22" (559 mm)	12" (305 mm)
Depth:	3-1/2" (89 mm)	3-1/2" (89 mm)	3-1/2" (89 mm)

**Architectural and Engineering Specifications:**  
The metal back box shall be constructed of 1.1 mm steel. UL listed and plenum rated, the MBX back boxes are code compliant. The MBX series is for

use with wood or metal framing. The back box shall measure 14-1/2" (368 mm) wide and be only 3-1/2" (89 mm) in depth. The back boxes shall also include all mounting screws and one sheet of insulation. The boxes will have both 1/2" (13 mm) and 3/4" (19 mm) knockouts for wire passage.

- Installation Notes:**
1. The back box interior should be insulated before speakers are installed.
  2. To avoid direct contact of woofer magnet to back of enclosure, a thin piece of foam (included in the accessory package) should be placed between the woofer magnet(s) and the box.
  3. Increased acoustical isolation is possible by using a visco-elastic acoustic barrier, such as Dynil™ by Dynamic Control (dynamat.com). This material is ultra pliable and only 0.09" thick, allowing it to fit behind the speaker panels.